



The
University
Of
Sheffield.

Sheffield

Eurosteel 9-11 September 2020





The
University
Of
Sheffield.

Eurosteel 2020 Sheffield

- The City of Steel is an iconic and historic location to present and discuss research work in the field of structural steel.
- The crucible and Bessemer processes, and pioneering stainless steel innovations made Sheffield steel famous worldwide.





The
University
Of
Sheffield.

About Sheffield

- One of the greenest and friendliest cities in Europe
- Located next to the Peak District National Park, an area of outstanding natural beauty
- An independent and alternative city with a thriving cultural scene

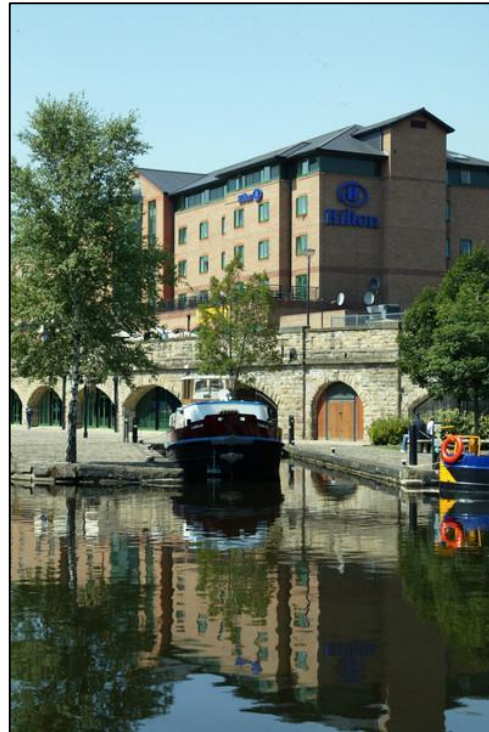



The
University
Of
Sheffield.

Things to see and do

- Chatsworth House
- Millennium Galleries
- Kelham Island Quarter
- Sheffield Theatres
- Winter Gardens
- The pubs





Getting to Sheffield

- Easy to reach from overseas destinations - 4 international airports less than an hour's drive from the city
- Manchester airport one hour by train - 2 hours by train from London
- Train departures every 30 minutes to St Pancras International
- The University campus is a 10 minute tram ride from Sheffield train station.



Getting around Sheffield



- Getting around is simple
- Sheffield has excellent public transport and everything is within easy walking distance
- The University campus is a 10 minute tram ride from Sheffield train station.

The University of Sheffield





The
University
Of
Sheffield.

About the University of Sheffield

- Member of the Russell Group of leading UK research universities
- Our outstanding performance for excellent teaching and research is consistently confirmed by international independent assessments.
- Truly international campus





The
University
Of
Sheffield.

Civil & Structural Engineering





The
University
Of
Sheffield.

Civil & Structural Engineering

- One of the biggest Civil & Structural Engineering departments in the UK
- Structural Engineering research includes fire engineering, earthquake engineering, optimization, low-carbon construction, blast and impact
- 100 years old this year





The
University
Of
Sheffield.





The
University
Of
Sheffield.





The
University
Of
Sheffield.

Conference at The Diamond



- State-of-the-art conference and lecture facility
- A unique interdisciplinary engineering building
- Teaching facilities, library and IT services
- Specialist engineering laboratories
- Situated in the city - easy to reach



The
University
Of
Sheffield.

Conference at The Diamond

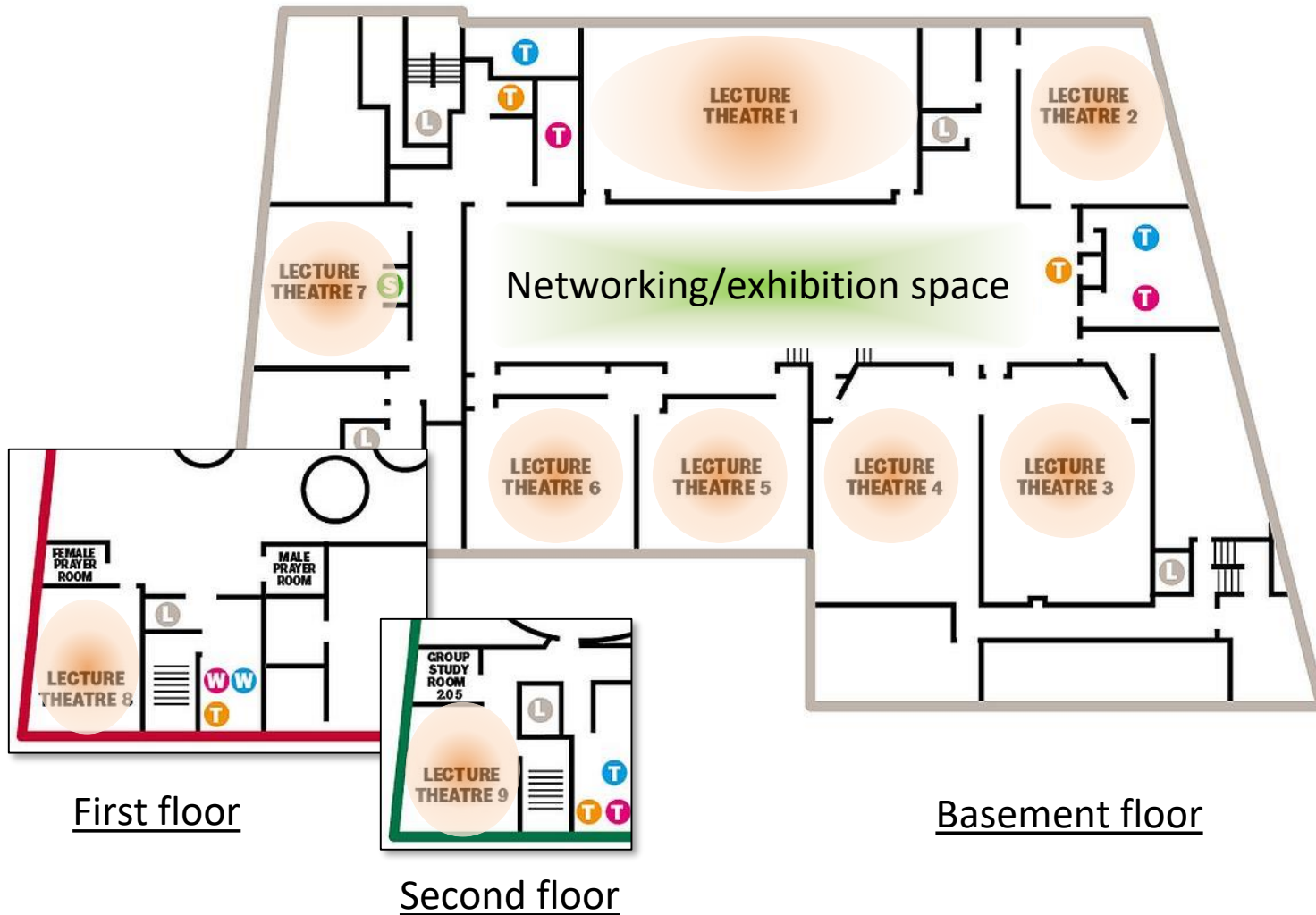



The
University
Of
Sheffield.

Conference at The Diamond

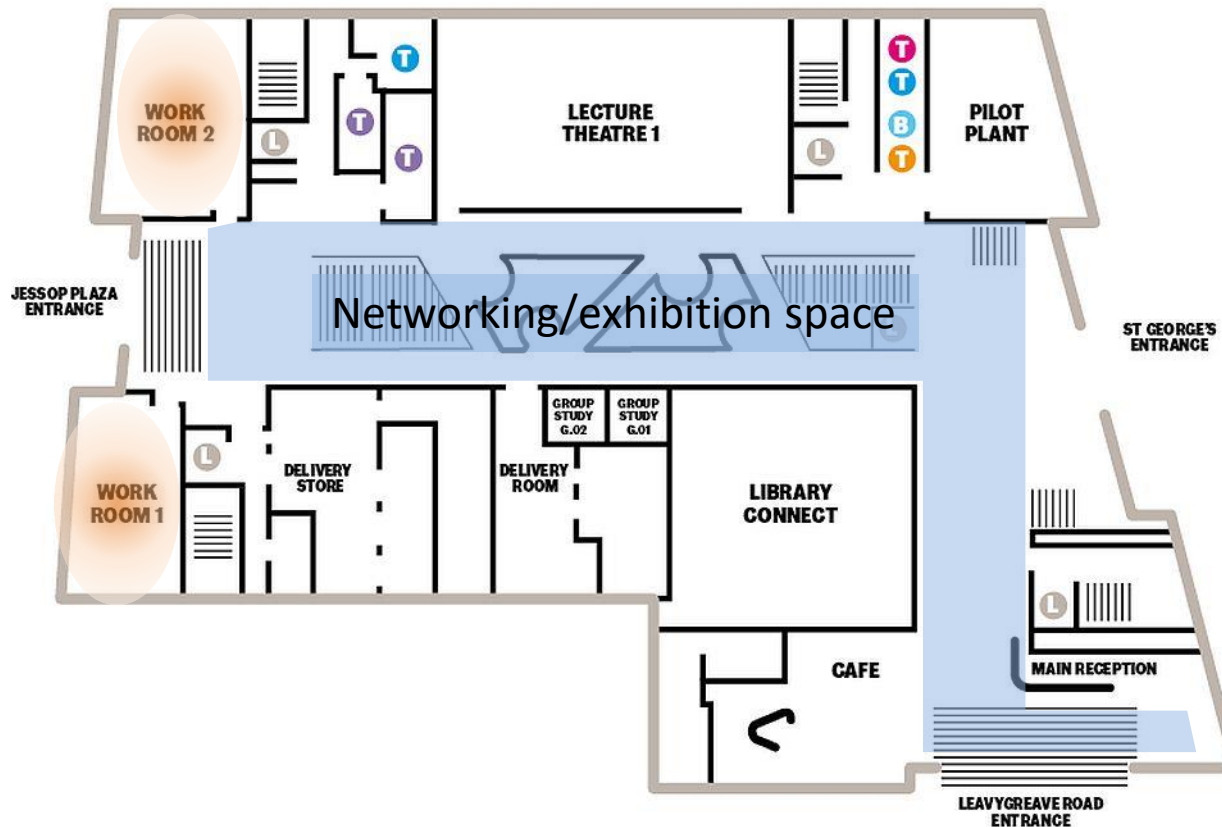

Ground floor



The
University
Of
Sheffield.

Conference at The Diamond

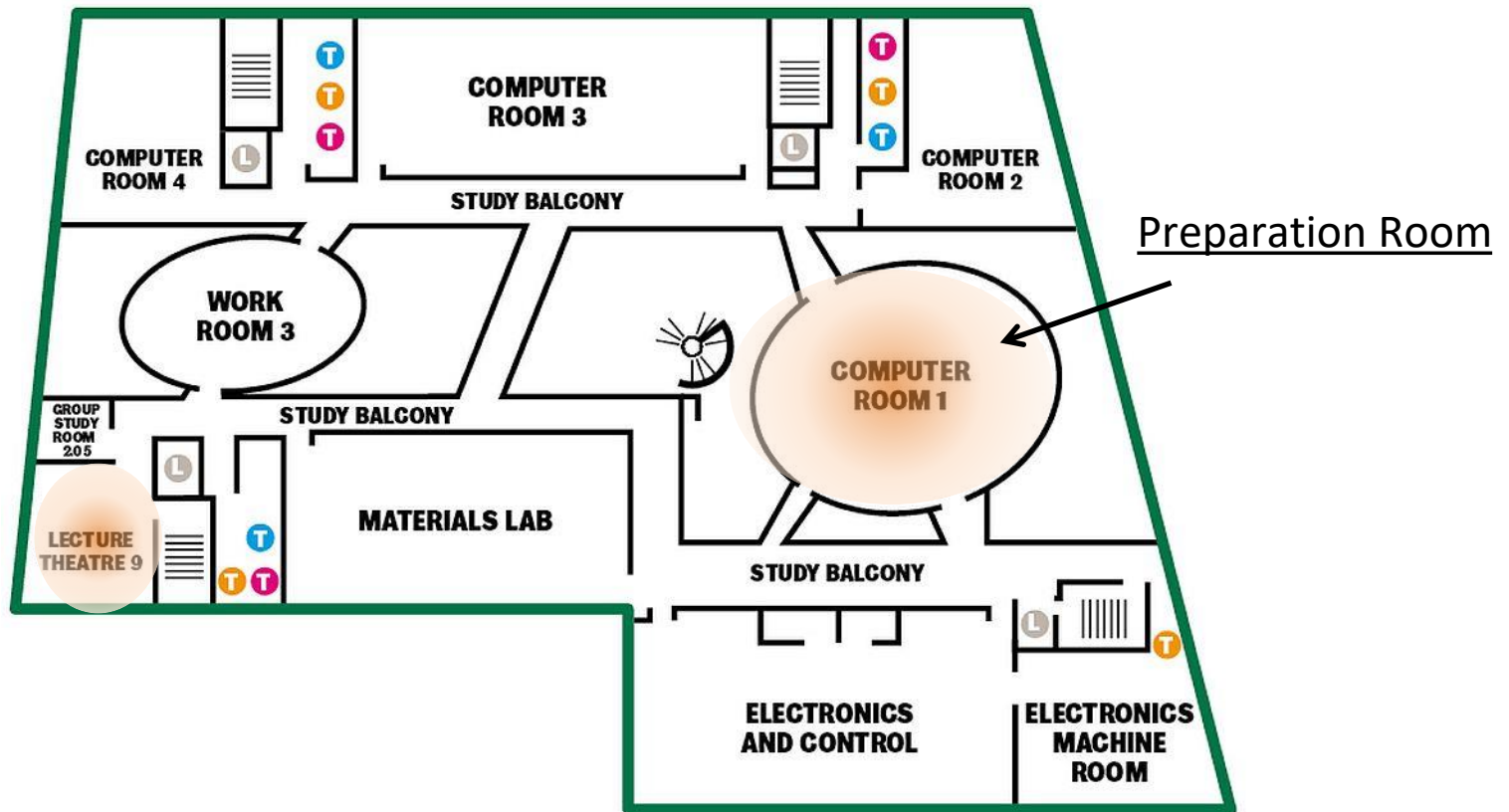

Second floor



The
University
Of
Sheffield.

Reception Dinner at Cutlers' Hall



- One of the finest livery halls in England
- Grade II listed and linked with Sheffield's cutlery and steel industrial heritage
- Renowned for top quality catering with fresh, locally sourced ingredients



The
University
Of
Sheffield.

Accommodation

- University of Sheffield accommodation offers a boutique Victorian hotel or individual bed & breakfast options in a student village
- Sheffield has an extensive range of hotels a short distance from the University - all budgets
- Bookings are easily made through our partner Marketing Sheffield





The
University
Of
Sheffield.

Registration fees

	Early bird registration by 1 June 2020	Standard registration after 1 June 2020
Regular participants	£450	£500
Young engineers	£310	£350
Accompanying persons	Free of charge	Free of charge
Banquet Dinner	£100	£100



The
University
Of
Sheffield.

Thank You

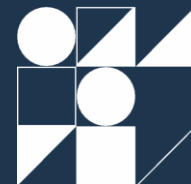

Engineering
at Sheffield.